

**LIFT  
PUSH  
BUTTON**

*SERIES 8R*

**PIXEL.**  
TECHNOLOGIES

*"Proudly Designed and Manufactured in  
Australia"*

[www.pixeltechnologies.com.au](http://www.pixeltechnologies.com.au)

# OUR PUSH BUTTONS

## DURABLE, STYLISH & AUSTRALIAN MADE

Designed and Manufactured in Australia to meet the highest standards in materials available from world class manufactures and suppliers.

A vandal resistant stainless steel button face, with in-built beeps and raised Braille for the visually impaired.

Dual illumination with contrasting colours that switch the standby LED off when the button command has acknowledged the controller.

## SPECIFICATIONS

- UL-94V0 Rated Polycarbonate Case
- Brushed Stainless Steel Button Face
- Illuminated Legend and Braille
- Dual Contacts with N/O & N/C Selectable
- Contacts rated at 125V-AC 3Amps 30V-DC 2Amps
- Contact resistance = 30mOhm
- Durability = 1,000,000 Presses Minimum
- Operating Temperatures = -25degC - 85degC
- Ambient Humidity = 60% maximum
- Button Voltage = 24V - DC
- LED Current = 15mAmps maximum
- Illuminated Arial Font With 15mm Character Height
- 31mm Diameter Button Area
- 50mm Mounting Stud Positioning
- 18mm Depth Compact Design

## BUTTON DIMENSIONS

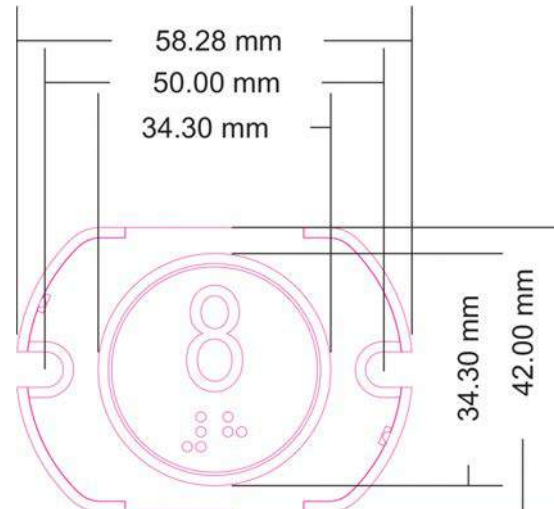

# OUR RANGE

ALL THE BUTTONS YOU WILL EVER NEED



UP ARROW



DOWN ARROW



PHONE



DOORS OPEN



DOORS CLOSE



GROUND FLOOR



LOWER GROUND



BASEMENT



MEZZANINE



FLOORS 1 TO 24



DISABILITY

# PUSH BUTTON FEATURES

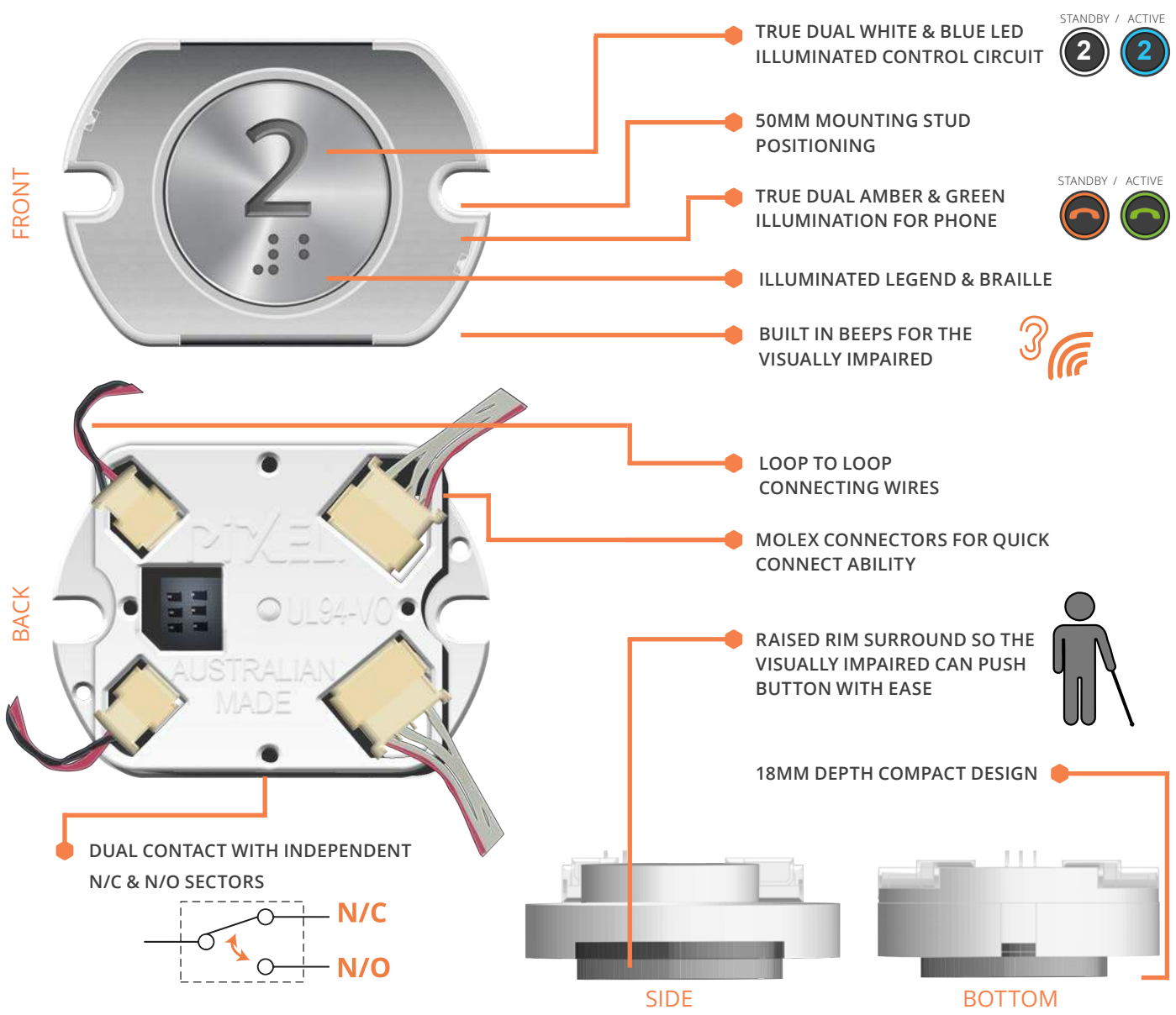

# EXTRA COMPONENTS

## PUSH BUTTON ADDITIONAL COMPONENTS

### CABLE INTERFACED CIRCUIT BOARD (A)

Part No: PB-1B12

Circuit Board (A) acts as a single wire interface to the trailer cable. It can power and transmit data for a maximum of 12 buttons.

(Sold separately to the buttons, one board needed for every 12 buttons)

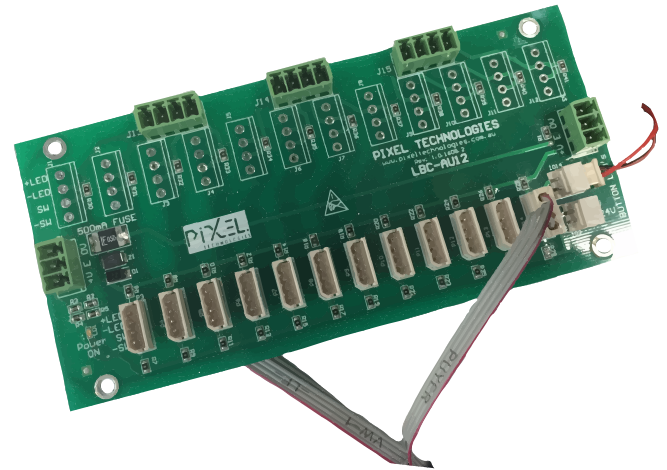

### CABLE INTERFACED CIRCUIT BOARD (B)

Part No: PB-2B12

Circuit Board (B) acts as a dual wire interface to the trailer cable. It can power and transmit data for a maximum of 12 buttons.

(Sold separately to the buttons, one board needed for every 12 buttons)

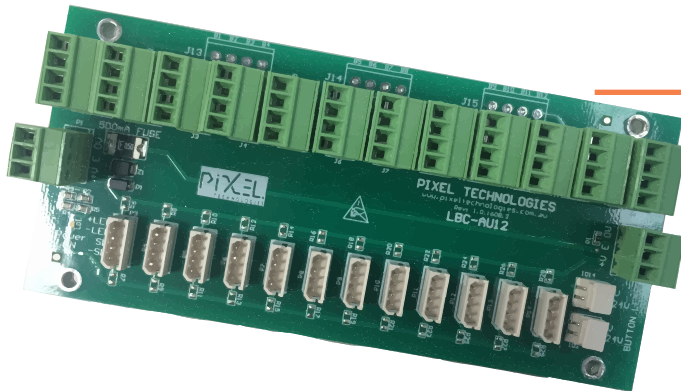

### PIXEL BUTTON 4 WAY CABLE LOOM

Single Part No: PB-CB1

12 Pack Part No: PB-CB12

The 4 Way Cable Loom connects from each button back to the cable interfaced circuit board.

(Sold separately to the buttons in a Single or 12 Pack)

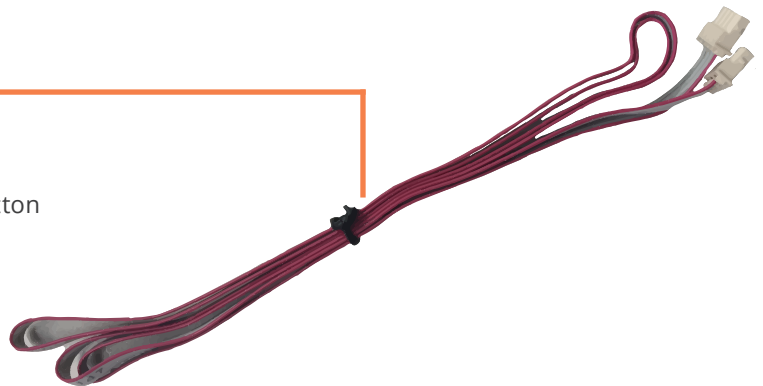



*"Proudly Designed and Manufactured in  
Australia"*

## Contact Us

---



+61 (03) 8843 0700



Bases in Melbourne, Brisbane,  
Sydney & Singapore.



[www.pixeltechnologies.com.au](http://www.pixeltechnologies.com.au)  
[info@pixeltechnologies.com.au](mailto:info@pixeltechnologies.com.au)

REVISION - 22.09.2016